

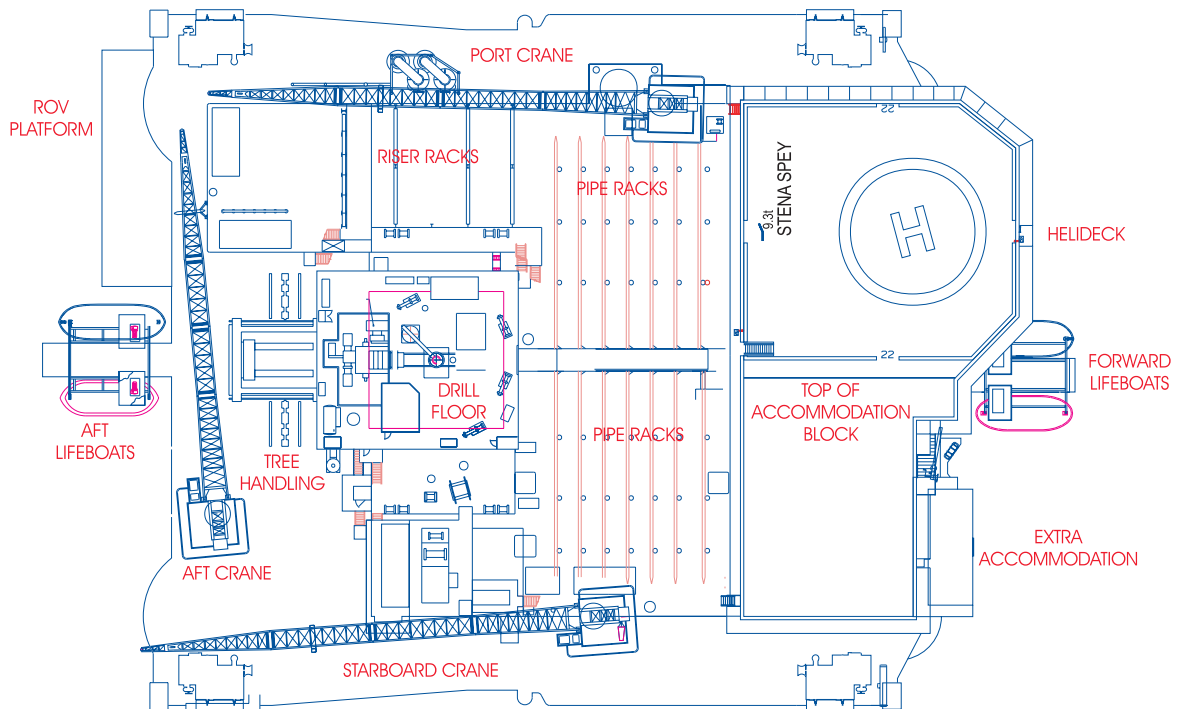

Stena Spey



GENERAL DESCRIPTION

STENA SPEY is a Friede & Goldman L907 (enhanced Pacesetter) twin pontoon, column stabilised self propelled, semi submersible offshore drilling unit.

The unit is capable of operations in severe environmental conditions in up to 1500 ft. (457.2m) of water. The Stena Spey has a SBOP capability for a water depth of 5,000ft.

CONSTRUCTION

The rig was built in the Daewoo shipyard in South Korea and delivered in June 1983.

PRINCIPAL CHARACTERISTICS

Length Overall	79.3m	(260 ft)
Width Overall	62.0m	(203 ft)
Keel to main deck	35.4m	(116 ft)
Pontoon Length	79.3m	(260 ft)
Pontoon Width	16.4m	(53 ft)
Pontoon Depth	7.6m	(25 ft)
Corner Caissons (4) Dia.	11.6m	(38 ft)
Intermediate Caissons (2) Dia.	10.7m	(35 ft)
Main Deck Length	72.0m	(236 ft)
Main Deck Width	63.4m	(208 ft)

Draft

Light transit	7.6m	(25 ft.)
Deep transit	9.14m	(30 ft)
Operating	19.8m	(65 ft)
Survival	15.24m	(50 ft.)

Displacement

Transit	21,019 tonnes
Survival	26,319 tonnes
Operating	29,797 tonnes

Deckloads

(Column Bulk 900 Tonne)

Transit	3350 tonnes
Survival	3450 tonnes
Operating	3850 tonnes

CLASSIFICATION

Det Norske Veritas Class *1A1 Column Stabilised Unit

HSE Accepted Safety Case

MCA Marine and Coastguard Agency

ACCOMMODATION

102	Man Accommodation
46	Two Man Cabins
2	One Man Cabins
2	Four-Man Cabins (Self contained unit)
1	Two Berth Hospital
2	Operator's Offices
2	Contractor's Offices
2	Recreation Rooms
1	Galley/Messroom
1	Hospital
1	Training Room

STORAGE CAPACITIES

Drill Water	10457 bbls	(1665m ³)
Potable Water	2117 bbls	(337m ³)
Fuel Oil	10253 bbls	(1632m ³)
Liquid Mud	2151 bbls	(342m ³)
Brine inc. mud dump	4700 bbls	(758m ³)
Brine no mud dump	2900 bbls	(468m ³)
Base Oil	1,824 bbls	(290 m ³)
Sack Storage	2,000 sacks	
Bulk Storage	830 tonnes	(502m ³)
Cement	330 tonnes	(222m ³)
Barite	417 tonnes	(194m ³)
Gel	83 tonnes	(86m ³)
Oil Mud Dump Tank (Emergency Only)	1,800 bbls	(290 m ³)

HEAVE COMPENSATION

Brown Brothers 20 ft stroke 600,000 lbs. capacity motion compensator
Maritime Hydraulics Active Heave Compensator w/ 17 ft stroke

CRANES

2 x National QS435 diesel hydraulic with 120ft. boom Port and Starboard
Capacity: 40 tonnes at 9 m/11 tonnes at 36.6 m
1 x National QS435 diesel hydraulic with 100ft. boom Aft
Capacity: 40 tonnes at 50 ft

POWER SUPPLY

4 x Bergen KVGB 12 diesel engines, 2753 BHP each driving 1 x NEBB
Norway/Wab 800-F8W Alternator producing 2750 Kva.

PROPULSION

2 Propellers each driven by 2 x 2000 HP electric motors

MOORING SYSTEM

4 x Norwinch Double windlasses
8 x Bruce FFTS 12 tonne HHP anchors
8 x 5000ft (ave.) lengths 76mm K4 quality anchor chain
Permanent chaser system

DRILLING EQUIPMENT

Derrick Height: 48.7m (180 ft)
Base: 40 ft x 40 ft
Load Capacity: 1.4 m lbs.

Crown Block NorMar 650 ton
7 x 60" Sheaves
1.3 m lb. capacity

Travelling Block National 650 ton
7 x 60" Sheaves

Rotary/Top Drive Rotary - National 49 1/2" opening rotary table
independent driven
Top Drive - Maritime Hydraulics 650 ton Top Drive
Maritime Hydraulics Auto Racking System

Drawworks 3000 HP National 1625 DE driven by 1 x 940 hp motor & 2 x 1000 hp motors.
Elmagco brake and Crown-O-Matic.

Mud Pumps 3 x National 12P - 160 1600 HP.
Tubulars 15000 ft. 5" S-135 Range 2 drillpipe 19.5 lbs/ft.
24 Jts. 5" OD HWDP
15 Jts. 6 3/4" OD HWDP
6 Jts. 9 1/2" OD DC
24 Jts. 8" OD DC
24 Jts. 6 1/2" OD DC

Iron Roughneck Maritime Hydraulics type MH 1898

Diverter Regan KFDS diverter 16" flowline and 10" overboard lines

BOP Stack Hydril 18 3/4" 15,000 psi WP H2S Service High Temp
2 x 15,000 psi WP Double Ram Preventers
1 x Hydril GX 10,000 psi lower annular
1 x Hydril GX 5,000 psi upper annular

BOP/Xmas Tree Handling 1 x NorMar BOP carrier
1 x NorMar service crane 17 ton SWL
1 x 60 ton Base Plate Trolley
BOP guidance system through moonpool

Riser 30 x 50 ft Joints 15,000 psi WP
Vetco MR 6C connectors. High Temp
1 x Kill 15k
1 x Choke 15k
1 x Booster Line 2k

Riser Tensioners 10 x 80K Brown Brothers tensioners 50ft line travel

Guideline Tensioners 4 x 16K Brown Brothers tensioners 40ft line travel

Podline Tensioners 2 x 16k Brown Brothers tensioners 40ft line travel



Stena Spey

www.stena-drilling.com